

SINGER
236U120,124,130,131



★ THE SINGER COMPANY

★ A Trademark of
THE SINGER COMPANY

PARTS FOR MACHINE No. 236 U 120

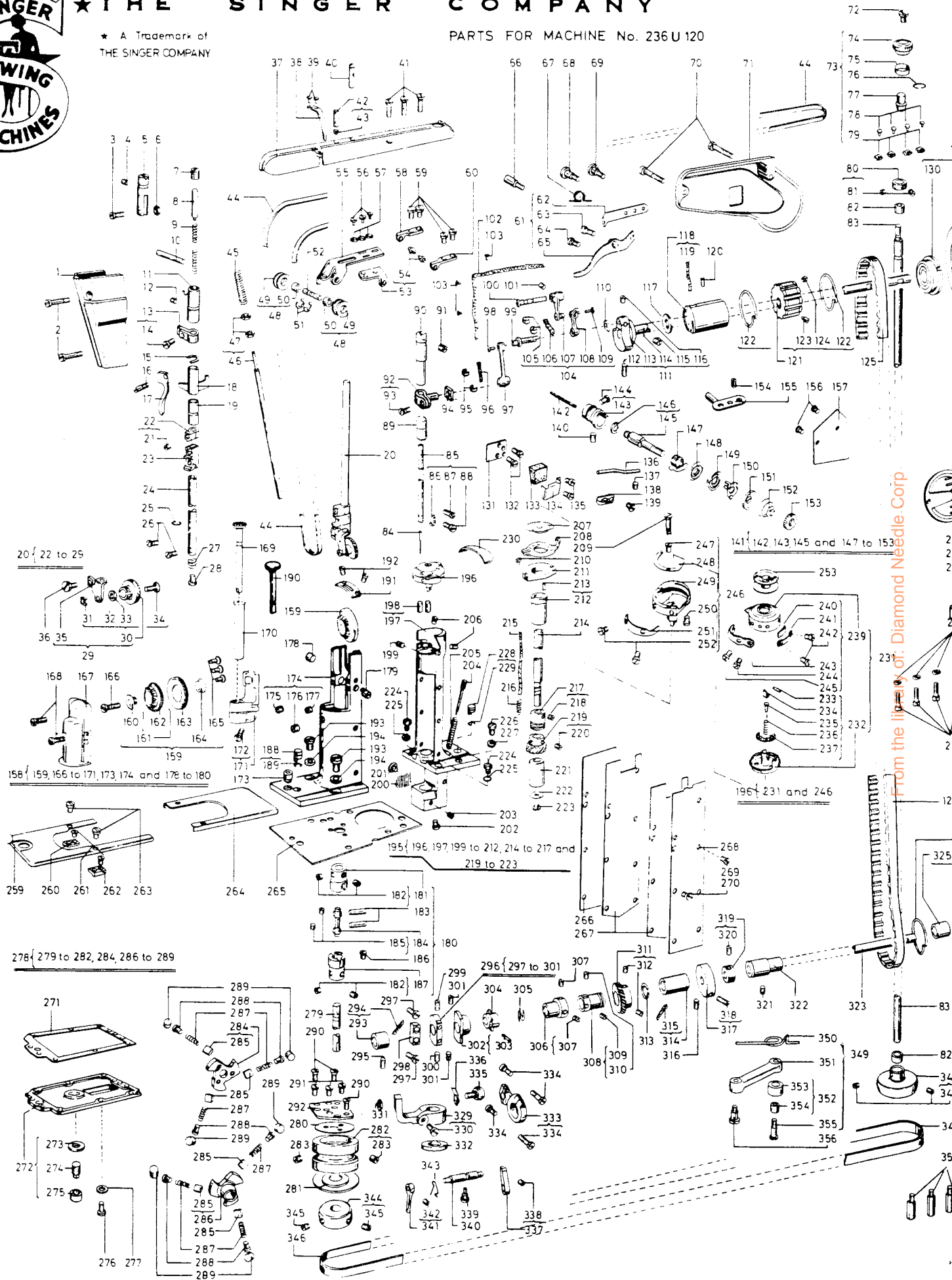

From the library of: Diamond Needle Corp

PARTS FOR MACHINE No. 236 U 124

Same as Machine No. 236 U 120 with the following exceptions:

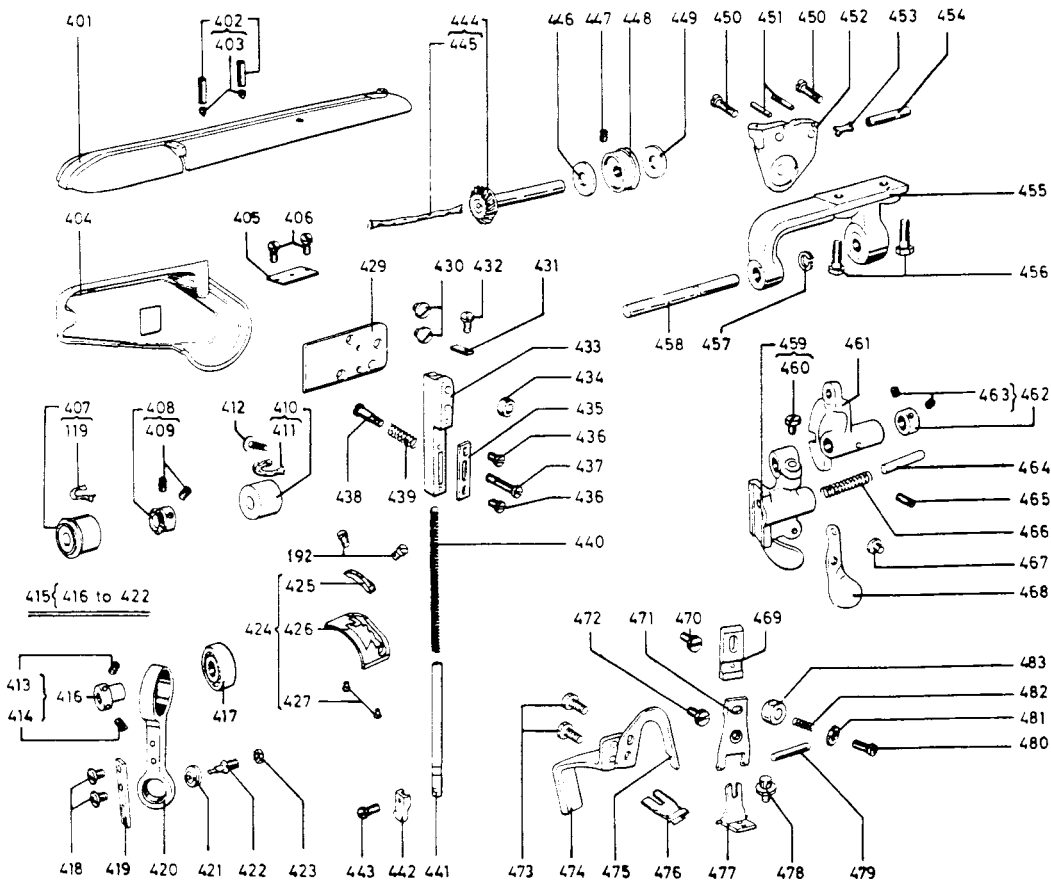

PARTS FOR MACHINE

Same as Machine No. 236 U 120 with the following exceptions:

For Parts not illustrated refer to

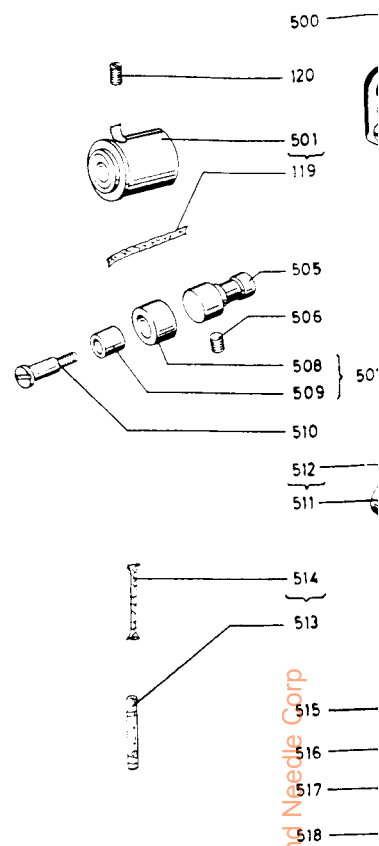

PARTS FOR MACHINE No. 236 U 130

Same as Machine No. 236 U 120 with the the following exceptions:
For Parts not illustrated refer to Machine No. 236 U 124 and U 132

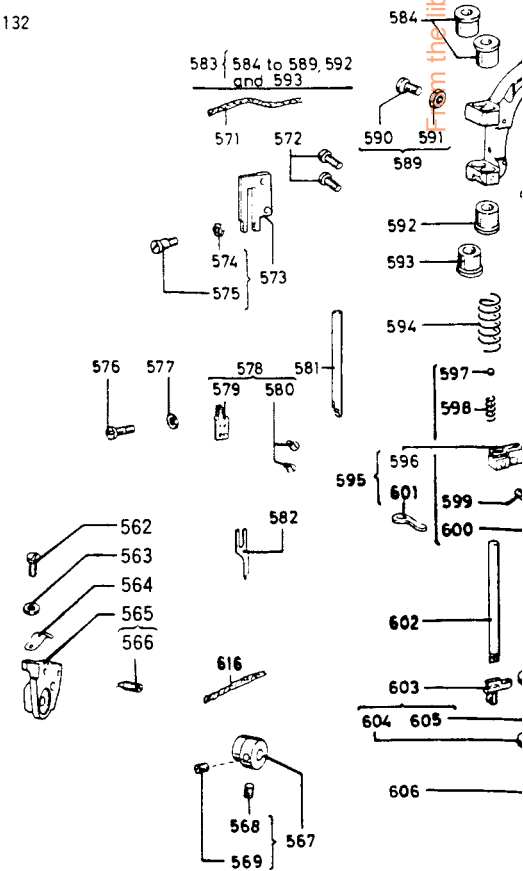
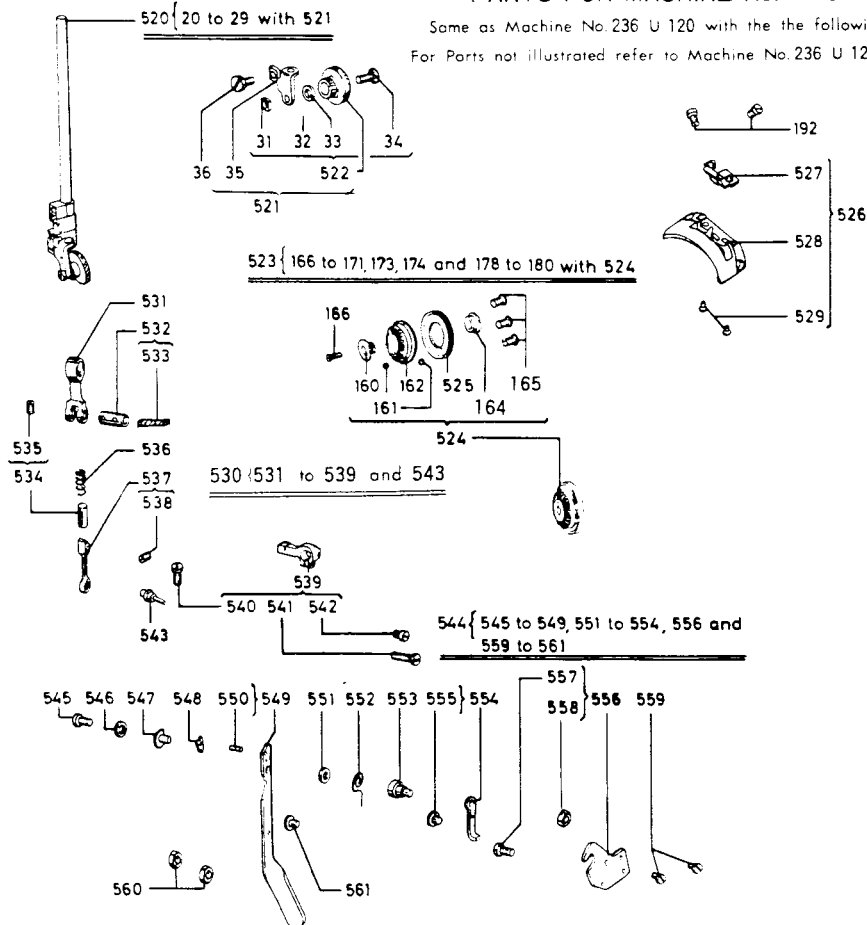

From the library of: Diamond Needle Corp

No. 236 U 132
 the following exceptions:
 Machine No. 236 U 124

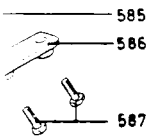
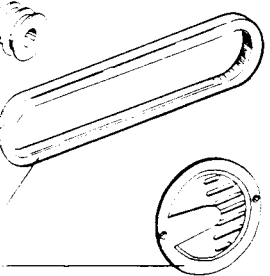
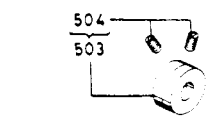
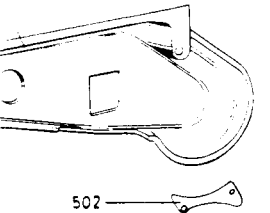

588

570 { 571 to 573, 576 to 578, 581, 583, 594, 595, 602, 603, 606-609 and 613

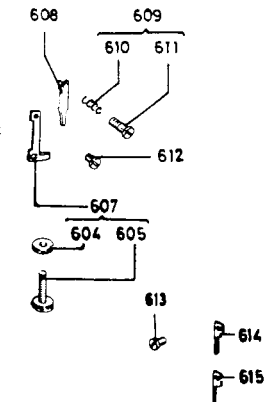

PARTS FOR MACHINE No. 236 U 131
 For Parts not illustrated refer to Machine No. 236 U 120

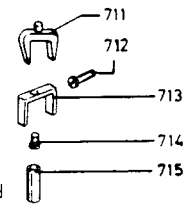
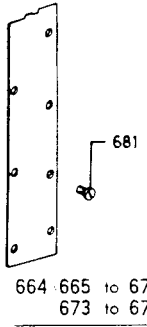
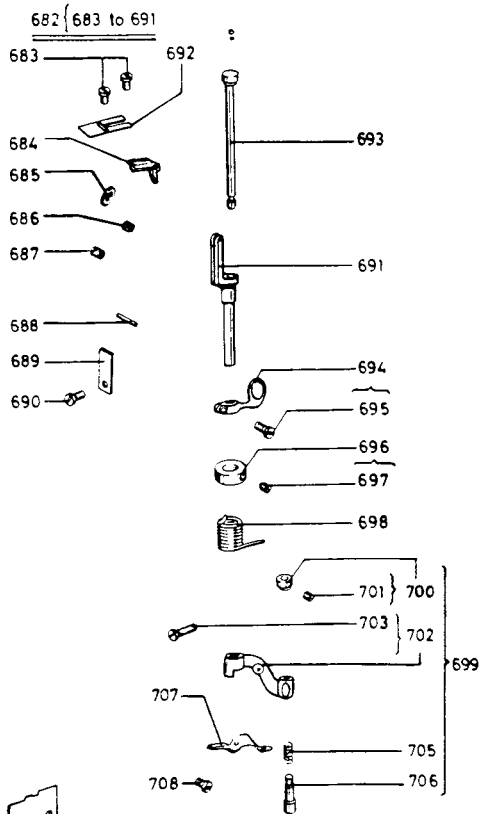
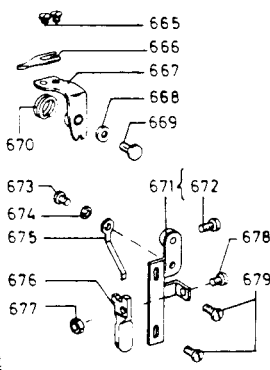
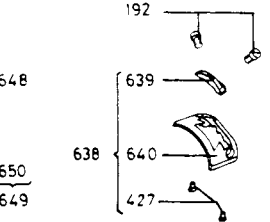
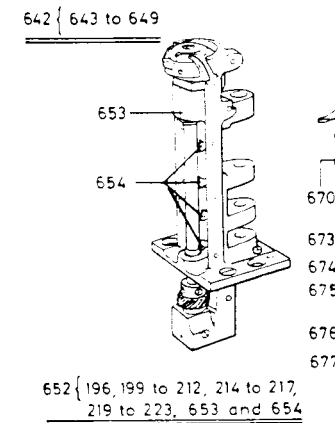
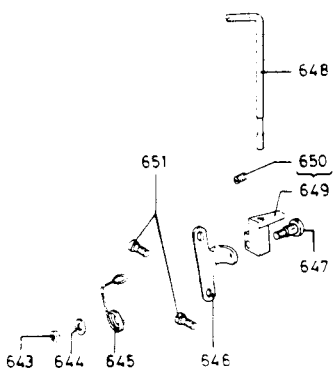
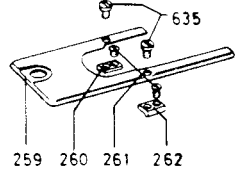
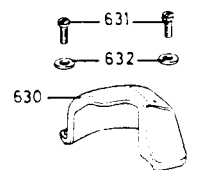

652 { 196, 199 to 212, 214 to 217, 219 to 223, 653 and 654

664 665 to 671 and 673 to 679

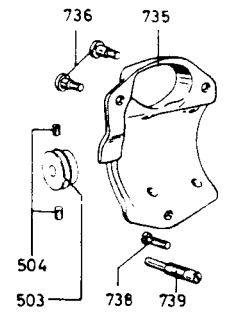
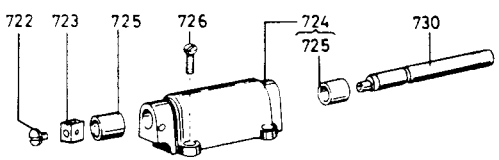
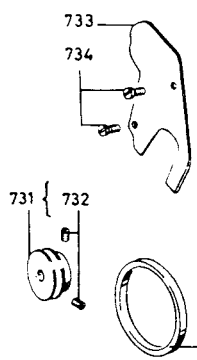
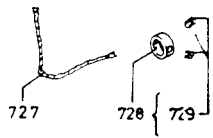
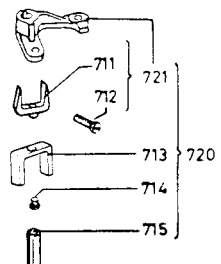

From the library of: Diamond Needle Corp

SINGER 236 U 120, 236 U 124, 236 U 130,
 236 U 131, 236 U 132

List of Parts 236U120/124/130/131 and 236U132 (Form U3)

Illustr. Ref. No.	Part No.	For Class				Name	Components	Illustr. Ref. No.	Part No.	For Class	
		120	124	130	131					120	131
1	263405	x	x	x	x	Arm End Cover		76	265329	x	x
2	416220	x	x	x	x	Arm End Cover Screw (2)					
3	416232	x	x	x	x	Presser Bar Position Guide Lever Stop Screw		77	416403	x	x
4	416283	x	x	x	x	Presser Bar Position Guide Set Screw					
5	416391	x	x	x	x	Presser Bar Position Guide		78	263528	x	x
6	416329	x	x	x	x	Presser Bar Position Guide Lever Stop Screw Nut					
7	416479	x	x	x	x	Presser Bar Screw (presser regulating)		79	263527	x	x
8	263499	x	x	x	x	Presser Bar Spring Stop Rod		80	416405	x	x
9	236089	x	x	x	x	Presser Bar Spring		81	416166	x	x
10	263546	x	x	x	x	Tension Releasing Plunger					
11	263496	x	x	x	x	Presser Bar Bushing (upper)					
12	416283	x	x	x	x	Presser Bar Bushing (upper) Set Screw		82	268425	x	x
13	416335	x	x	x	x	Presser Bar Position Guide Lever					
14	416239	x	x	x	x	Presser Bar Position Guide Lever Pinch Screw		83	416404	x	x
15	206608	x	x	x	x	Presser Bar Lifting Releasing Leber Bracket Spring		84	Cat. 1740	x	x
16	416292	x	x	x	x	Presser Bar Lifter Hinge Screw		85	416389	x	x
17	202671	x	x	x	x	Presser Bar Lifter		86	249270	x	x
18	263497	x	x	x	x	Presser Bar Lifting Releasing Lever Bracket		87	416254	x	x
19	263495	x	x	x	x	Presser Bar Bushing (lower)		88	200125-833	x	x
20	416395	x	x	x	x	Roller Presser Bar and Bar Cpl.	416243, two 416249, 202558, 202559, 416343, 416351, 416350, 416393, 416394	89	263490	x	x
								90	263491	x	x
								91	416283	x	x
								92	416218	x	x
								93	416167	x	x
								94	143058	x	x
21	416270	x	x	x	x	Roller Presser Arm Bracket Position Collar Set Screw		95	263571	x	x
22	416351	x	x	x	x	Roller Presser Arm Bracket Position Collar Cpl.	416270				
23	416350	x	x	x	x	Roller Presser Arm Bracket		96	265370	x	x
24	416394	x	x	x	x	Roller Presser Bar		97	263492	x	x
25	416343	x	x	x	x	Roller Presser Arm Bracket Position Collar Lock Ring		98	504057	x	x
								99	416454	x	x
26	416249	x	x	x	x	Roller Presser Arm Bracket Spring Stop Screw (2)		100	263544	x	x
27	202558	x	x	x	x	Roller Presser Arm Bracket Spring		101	416267	x	x
28	202559	x	x	x	x	Roller Presser Arm Bracket Spring Stop		102	263560	x	x
29	416393	x	x	x	x	Roller Presser Arm Cpl.	416392, 416488	103	228485	x	x
30	416488	x	x	x	x	Roller Presser Cpl.	1528, 201699, Twenty-Eight 206417, 350104				
31	1528-819	x	x	x	x	Roller Presser Hinge Screw Nut		104	263539	x	x
32	206417	x	x	x	x	Roller Presser Ball 1/16" φ (28)		105	263571	x	x
33	201699-803	x	x	x	x	Roller Presser Ball Cone		106	263572	x	x
34	350104-803	x	x	x	x	Roller Presser Hinge Screw		107	263543	x	x
35	416392	x	x	x	x	Roller Presser Arm		108	263538	x	x
36	416243	x	x	x	x	Roller Presser Arm Screw		109	12166	x	x
37	416363	x	x	x	x	Arm Top Cover		110	263545	x	x
38	263541	x	x	x	x	Take-Up Lever Guard		111	416411	x	x
39	416251	x	x	x	x	Take-Up Lever Guard Screw (2)					
40	416336	x	x	x	x	Thread Guide		112	416264	x	x
41	416256	x	x	x	x	Arm Top Cover Screw (3)		113	*416390	x	x
42	263590	x	x	x	x	Arm Top Cover Oil Tube Cpl.	170168	114	*263406	x	x
43	170168	x	x	x	x	Arm Top Cover Oil Tube Metering Insert		115	416270	x	x
44	263515	x	x	x	x	Roller Presser Driving Belt (upper)		116	416277	x	x
45	263521	x	x	x	x	Roller Presser Driving Belt (upper) Idler Pulley Bracket Adjusting Rod Spring		117	203172	x	x
								118	263408	x	x
46	416401	x	x	x	x	Roller Presser Driving Belt (upper) Idler Pulley Bracket Adjusting Rod Cpl.	Two 416321	119	203100	x	x
47	416321	x	x	x	x	Roller Presser Driving Belt (upper) Idler Pulley Bracket Adjusting Rod Nut and Lock Nut (2)		120	416265	x	x
								121	416362	x	x
48	263556	x	x	x	x	Roller Presser Driving Belt (upper) Idler Pulley Cpl. (2)	Two 263517, two 263565	122	214206	x	x
49	263517	x	x	x	x	Roller Presser Driving Belt (upper) Idler Pulley (2)		123	416476	x	x
50	263565	x	x	x	x	Roller Presser Driving Belt (upper) Idler Pulley Needle Bearing (2)		124	416271	x	x
51	263564	x	x	x	x	Roller Presser Driving Belt (upper) Idler Pulley Spindle Retaining Ring (2)		125	263409	x	x
								126	416388	x	x
52	263526	x	x	x	x	Roller Presser Driving Belt (upper) Idler Pulley Spindle		127	416387	x	x
								128	416262	x	x
53	416402	x	x	x	x	Roller Presser Driving Belt (upper) Idler Pulley Bracket Extension Cpl.	Two 263523	129	416263	x	x
								130	272142	x	x
54	263523	x	x	x	x	Roller Presser Driving Belt (upper) Idler Pulley Bracket Extension Center (2)		131	416409	x	x
								132	416288	x	x
55	263518	x	x	x	x	Roller Presser Driving Belt (upper) Idler Pulley Bracket		133	241765	x	x
								134	263554	x	x
56	416208	x	x	x	x	Roller Presser Driving Belt (upper) Idler Pulley Bracket Extension Screw (3)		135	416248	x	x
								136	263558	x	x
57	208636	x	x	x	x	Roller Presser Driving Belt (upper) Idler Pulley Bracket Extension Screw Washer (3)		137	416477	x	x
								138	210954	x	x
58	263524	x	x	x	x	Roller Presser Driving Belt (upper) Idler Pulley Bracket Extension Support (back)		139	416289	x	x
								140	446-833	x	x
59	416317	x	x	x	x	Roller Presser Driving Belt (upper) Idler Pulley Bracket Extension Support Screw (4)		141	416407	x	x
60	263525	x	x	x	x	Roller Presser Driving Belt (upper) Idler Pulley Bracket Extension Support (front)					
61	416386	x	x	x	x	Lifting Lever Cpl.	416241, 416035, 416385, 263484	142	263548	x	x
								143	416408	x	x
62	263484	x	x	x	x	Lifting Lever Extension		144	504047	x	x
63	416241	x	x	x	x	Lifting Lever Extension Screw		145	416480	x	x
64	416035	x	x	x	x	Lifting Lever Spring Stop Screw (on Lever)		146	*263550	x	x
65	416385	x	x	x	x	Lifting Lever		147	202410	x	x
66	416314	x	x	x	x	Lifting Lever Stop Screw		148	244048	x	x
67	263485	x	x	x	x	Lifting Lever Spring		149	244049	x	x
68	416308	x	x	x	x	Lifting Lever Hinge Screw		150	263547	x	x
69	416258	x	x	x	x	Lifting Lever Spring Stop Screw (on Arm)		151	263549	x	x
70	416223	x	x	x	x	Arm Cover (back) Screw (2)		152	223438	x	x
71	263634	x	x	x	x	Arm Cover (back)		153	416326	x	x
72	416309	x	x	x	x	Roller Presser Driving Belt (upper) Pulley (adjustable) Stop Screw		154	416311	x	x
								155	240034	x	x
73	416165	x	x	x	x	Roller Presser Driving Belt (upper) Pulley (adjustable) Cpl.	416334, Four 263527, Four 263528, 263529, 263530, 416403	156	416245	x	x
								157	263404	x	x
								158	416455	x	x
74	416334	x	x	x	x	Roller Presser Driving Belt (upper) Pulley (adjustable) Lock Nut					
75	263530	x	x	x	x	Roller Presser Driving Belt (upper) Pulley (adjustable) Segment Ring					

From the library of Diamond Needle Corp

s	31	132	Name	Components	Illustr. Ref. No.	Part No.	For Class				Name
							120	124	130	131	
x	x		Roller Presser Driving Belt (upper) Pulley (adjustable) Segment Retaining Ring		159	416168	x	x	x	x	Feed Wheel Cpl.
x	x		Roller Presser Driving Belt (upper) Pulley (adjustable) Spreader Cone		160	416374	x	x	x	x	Feed Wheel Ball Cone (outside)
x	x		Roller Presser Driving Belt (upper) Pulley (adjustable) Segment Guide Stud (4)		161	206417	x	x	x	x	Feed Wheel Ball 1/16" φ (60)
x	x		Roller Presser Driving Belt (upper) Pulley (adjustable) Segment (4)		162	416375	x	x	x	x	Feed Wheel Bevel Gear
x	x		Roller Presser Driving Belt (upper) Pulley (adjustable) Segment (4)		163	263660	x	x	x	x	Feed Wheel
x	x		Roller Presser Driving Belt Shaft Collar Cpl.	Two 416166	164	416373	x	x	x	x	Feed Wheel Ball Cone (inside)
x	x		Roller Presser Driving Belt Shaft Collar Set Screw (2)		165	416290	x	x	x	x	Feed Wheel Bevel Gear Screw (3)
x	x		Roller Presser Driving Belt Shaft Needle Bearing (lower and upper) (2)		166	416274	x	x	x	x	Feed Wheel Cap Screw
x	x		Roller Presser Driving Belt Shaft Needle Bar Cpl.		167	263829	x	x	x	x	Feed Post Cover (side)
x	x		Needle Bar Thread Guide		168	545318	x	x	x	x	Feed Post Cover (side) Screw (2)
x	x		Needle Bar Thread Guide Screw		169	416161	x	x	x	x	Feed Wheel Bevel Gear Driving Pinion
x	x		Needle Bar Bushing (lever)		170	263461	x	x	x	x	Feed Wheel Bracket Extension
x	x		Needle Bar Bushing (upper)		171	416379	x	x	x	x	Feed Wheel Bracket Cpl.
x	x		Needle Bar Connecting Stud Col.	200125, 416254, 249270	172	416227	x	x	x	x	Feed Wheel Bracket Pinch Screw
x	x		Needle Bar Connecting Stud Pinch Screw		173	263849	x	x	x	x	Oil Reservoir Oil Gauge Plug
x	x		Needle Bar Connecting Stud Slide Block		174	416461	x	x	x	x	Feed Post with
x	x		Needle Bar Connecting Stud Oil Packing (wick) Spring Clamp (2)		175	504020	x	x	x	x	Feed Wheel Bracket Friction Plug Set
x	x		Needle Bar Connecting Link Oil Packing (wick) Spring Clamp (2)		176	448-833	x	x	x	x	Feed Wheel Bracket Extension Set Screw
x	x		Needle Bar Connecting Link		177	504020	x	x	x	x	Feed Wheel Adjusting Stud Set Screw
x	x		Needle Bar Connecting Link Cap Screw		178	249019	x	x	x	x	Feed Wheel Bracket Friction Plug
x	x		Take-Up Lever Crank		179	249092	x	x	x	x	Feed Wheel Adjusting Stud
x	x		Take-Up Lever Link Hinge Stud		180	416162	x	x	x	x	Feed Wheel Bevel Gear Driving Pinion
x	x		Take-Up Lever Link Hinge Stud Set Screw								Coupling Cpl.
x	x		Needle Bar and Take-Up Oiling Wick		181	416377	x	x	x	x	Feed Wheel Bevel Gear Driving Pinion
x	x		Needle Bar and Take-Up Oiling Wick Retaining Screw (3)		182	416277	x	x	x	x	Coupling (upper) Cpl.
x	x		Take-Up Lever Complete	12166, 263538, 263543, two 263571, 263572	183	263457	x	x	x	x	Feed Wheel Bevel Gear Driving Pinion
x	x		Take-Up Lever Link Oil Packing (wick) Spring Clamp		184	416378	x	x	x	x	Coupling Set Screw (4)
x	x		Take-Up Lever Link Oil Packing (wick)		185	416306	x	x	x	x	Feed Wheel Bevel Gear Driving Pinion
x	x		Take-Up Lever Link		186	416247	x	x	x	x	Coupling Ball Connection Stud (2)
x	x		Take-Up Lever		187	416376	x	x	x	x	Feed Wheel Bevel Gear Driving Pinion
x	x		Take-Up Lever Hinge Stud		188	263440	x	x	x	x	Ball Connection Retaining Screw
x	x		Take-Up Lever Position Plate		189	263441	x	x	x	x	Feed Wheel Bevel Gear Driving Pinion (lower) Cpl.
x	x		Arm Shaft Cpl.	*263406, *416390, 416264, 416277, 416270	190	263848	x	x	x	x	Feed Post Adjusting Eccentric Stud C
x	x		Needle Bar Crank Position Screw		191	263836	x	x	x	x	Feed Post Adjusting Eccentric Stud R
x	x		Needle Bar Crank		192	141664-819	x	x	x	x	Ring
x	x		Arm Shaft		193	416309	x	x	x	x	Oil Reservoir Oil Gauge
x	x		Take-Up Lever Crank Set Screw		194	263592	x	x	x	x	Throat Plate
x	x		Take-Up Lever Crank Set Screw		195	416457	x	x	x	x	Throat Plate Screw (2)
x	x		Needle Bar Crank Friction Washer								Feed Post Screw (2)
x	x		Arm Shaft Bushing (front) with								Feed and Hook Post Screw Washer (fi
x	x		Arm Shaft Bushing (front) Oil Packing (wick)								Hook Post Cpl.
x	x		Arm Shaft Bushing (front) Set Screw								
x	x		Arm Shaft Connection Belt Pulley Cpl.	203100	196	263464	x	x	x	x	Hook and Bobbin Case Cpl.
x	x		Arm Shaft Connection Belt Pulley Spring Flange (2)		197	416456	x	x	x	x	Hook Post with
x	x		Arm Shaft Connection Belt Pulley Position Screw		198	263582	x	x	x	x	Bobbin Case Lever Slide Stud Base Pc
x	x		Arm Shaft Connection Belt Pulley Position Screw Check Screw/Set Screw (2)		199	544322	x	x	x	x	Pin (2)
x	x		Arm Shaft Connection Belt (reinforced neoprene)		200	263476	x	x	x	x	Hook Shaft (vertical) Bearing (upper)
x	x		Machine Pulley with	416387, 272142	201	545342	x	x	x	x	Hook Post Oil Inlet Strainer
x	x		Machine Pulley Cpl.	416262, 416263	202	416136	x	x	x	x	Hook Post Oil Inlet Strainer Screw
x	x		Machine Pulley Set Screw		203	544322	x	x	x	x	Hook Post Oil Stop Screw
x	x		Machine Pulley Position Screw		204	416215	x	x	x	x	Hook Shaft (vertical) Bearing (lower)
x	x		Arm Shaft Ball Bearing (back)		205	234426	x	x	x	x	Hook Oil Regulating Screw
x	x		Thread Lubricator Plate		206	544303	x	x	x	x	Hook Oil Regulating Spring
x	x		Thread Lubricator Plate Screw (2)		207	263482	x	x	x	x	Bobbin Case Lever Slide Stud Base Se
x	x		Thread Lubricator Oil Pad (felt)		208	263826	x	x	x	x	Hook Washer
x	x		Thread Lubricator Oil Pad Holder		209	416478	x	x	x	x	Bobbin Case Lever
x	x		Thread Lubricator Oil Pad Holder Screw (2)		210	203478	x	x	x	x	Hook Shaft (vertical) Screw
x	x		Thread Retainer Thread Guide		211	263421	x	x	x	x	Bobbin Case Lever Slide Stud
x	x		Thread Retainer Thread Guide Set Screw		212	263480	x	x	x	x	Bobbin Case Lever Slide Stud Base (a
x	x		Thread Guide (lever)		213	263561	x	x	x	x	Hook Shaft (vertical) Bearing (upper)
x	x		Thread Guide (lever) Set Screw		214	416169	x	x	x	x	Hook Shaft (vertical) Bearing (upper)
x	x		Thread Controller Spring Regulator Set Screw		215	263593	x	x	x	x	Hook Shaft (vertical)
x	x		Tension Cpl.	202410, 223438, 244048, 244049, 263547, 263548, 263549, 416326, 416480, 416408	216	416413	x	x	x	x	Hook Shaft (vertical) Oil Packing (wic
x	x		Tension Releasing Pin		217	416410	x	x	x	x	Hook Shaft (vertical) Sleeve (center)
x	x		Thread Controller Spring Regulator Cpl.		218	416280	x	x	x	x	Hook Shaft (vertical) Sleeve (center)
x	x		Tension Stud Set Screw		219	416466	x	x	x	x	Hook Shaft (vertical) Sleeve (center)
x	x		Tension Stud Cpl.		220	416277	x	x	x	x	Hook Driving Pinion Cpl.
x	x		Tension Stud Washer		221	263479	x	x	x	x	Hook Driving Pinion Set Screw (2)
x	x		Thread Controller Spring		222	263481	x	x	x	x	Hook Shaft (vertical) Bearing (lower)
x	x		Tension Disc (back)		223	416170	x	x	x	x	Hook Shaft (vertical) Thrust Washer
x	x		Tension Disc (front)		224	416309	x	x	x	x	Hook Shaft (vertical) Thrust Washer S
x	x		Tension Release Washer		225	263592	x	x	x	x	Hook Post Screw (2)
x	x		Tension Spring Washer		226	416216	x	x	x	x	Feed and Hook Post Screw Washer (fi
x	x		Tension Spring		227	244746	x	x	x	x	Hook Post Oil Hole Screw
x	x		Tension Thumb Nut		228	263440	x	x	x	x	Hook Post Oil Hole Screw Seal
x	x		Thread Retainer Set Screw		229	263441	x	x	x	x	Hook Post Adjusting Eccentric Stud C
x	x		Thread Retainer		230	263846	x	x	x	x	Hook Post Adjusting Eccentric Stud F
x	x		Arm Cover Plate (back) (lower) Screw (2)		231	241677	x	x	x	x	Hook Post Slide
x	x		Arm Cover Plate (back) (lower)		232	235769	x	x	x	x	Bobbin Case Cpl.
x	x		Feed Post Cpl.	Two 545318, 249019, 249092, 416161, 263461, 416379, 416168, 263829, 416161, 263849, 416461, 416274	233	*202056	x	x	x	x	Bobbin Case Base Latch Pin
					234	*203211	x	x	x	x	Bobbin Case Base Latch
					235	*203212	x	x	x	x	Bobbin Case Base Latch Plunger
					236	*203213	x	x	x	x	Bobbin Case Base Latch Spring
					237	203216	x	x	x	x	Bobbin Case Washer (cloth)
					239	241676	x	x	x	x	Bobbin Case Cap Cpl.
					240	241674	x	x	x	x	Bobbin Case Oiling Felt

From the library of: Diamond Needle

Components	Illustr. Ref. No.	Part No.	For Class			Name	Components
			120	130	132		
Three 416290, Sixty 206417, 416374, 416375, 263660, 416373	241 242 243 244 245 246	241675 350405 235771 200594-805 200984-803 263463	x x x x x	x x x x x	x x x x x	Bobbin Case Oiling Felt Retainer Bobbin Case Oiling Felt Retainer Screw (2) Bobbin Case Tension Spring Bobbin Case Tension Spring Screw Bobbin Case Tension Spring Regulating Screw Hook Cpl.	201253, two 201409, 201376, 241604, *263462, 263563
	247 248 249 250 251 252 253	201253-806 241604 263462 201376-803 263563 201409-806 233939	x x x x x	x x x x x	x x x x x	Hook Gib Screw Hook Gib Hook (sewing) Hook Gib Hinge Screw Hook Needle Guard Hook Needle Guard Screw (2) Bobbin	
416227	254 255 256	263403 416287 204235	x x x	x x x	x x x	Arm Cover (front) Arm Cover (front) Screw (2) Arm Base Position and Arm Position Pin (4)	
448, two 504020	257 258 259 260 261 262	202005 416221 263801 416453 416210 416452	x x x x x	x x x x x	x x x x x	Arm Base Screw and Arm Screw Washer (6) Arm Base and Arm Screw (6) Feed Post Base Cover Feed and Hook Post Base Cover Support (back) Feed and Hook Post Base Cover Support Screw (2)	
416247, 416376, 416377, 416378, two 263457	263 264 265 266 267 268 269 270	416255 263802 263812 263830 263832 263845 504110 416217	x x x x x	x x x x x	x x x x x	Feed and Hook Post Base Cover Screw (2) Hook Post Base Cover Feed and Hook Post Gasket (bottom) Feed and Hook Post Cover (back) Feed and Hook Post Cover Gasket (back or front) (2) Feed and Hook Post Cover (front) Feed and Hook Post Cover (back or front) Screw (8) Feed and Hook Post Cover (back or front) Clamp Screw (6)	
Two 416306	271 272 273	263415 416365 263459	x x x x x	x x x x x	x x x x x	Bed Cover (bottom) Gasket Bed Cover (bottom) Cpl. Feed Wheel Bevel Gear Driving Pinion Shaft (lower) Needle Bearing Oil Seal	263459, 267093, 416487
Two 416277 263441	274 275 276 277 278	416487 267093 416226 272154 416366	x x x x x	x x x x x	x x x x x	Bed Cover (bottom) Screw Oil Plug Feed Wheel Bevel Gear Driving Pinion Shaft (lower) Needle Bearing Bed Cover (bottom) Screw (10) Bed Cover (bottom) Screw Washer (fibre) (2) Feed Clutch Cpl.	Six 68152, Six 131717, Six 131718, 144261, 263423, 263458, 416171, 263579, 263591
416136, 545342, two 544322 544303, 416170, 416215, 203478, 234426, 263421, 263464, 263476, 416169, 263479, 263480, 263481, 416466, 263482, 416410, 263593, 263826, 416413, 416456, 416478 241677, 263463 Two 263582	279 280 281 282 283 284 285 286 287 288 289 290 291 292 293 294	263458 263591 144261 263579 140409-830 416171 263574 263423 131718 68152 131717 416917 1255-803 263424 263467 272115	x x x x x	x x x x x	x x x x x	Feed Wheel Bevel Gear Driving Pinion Shaft (lower) Feed Clutch Thrust Washer Feed Clutch (drive) Washer Feed Clutch Sleeve Feed Clutch Sleeve Set Screw (2) Feed Clutch (brake) with Feed Clutch Wear Plate (6) Feed Clutch (drive) with Feed Clutch Roller Spring (6) Feed Clutch Roller Plunger (6) Feed Clutch Roller (6) Feed Clutch (brake) Supporting Plate Screw (3) Feed Clutch (brake) Screw (3) Feed Clutch (brake) Supporting Plate Hook and Feed Driving Shaft Bushing (front) with Hook and Feed Driving Shaft Bushing (front) Oil Packing (wick) Hook and Feed Driving Shaft Bushing (front) Set Screw	Three 263574 Three 263574
	295 296 297 298 299 300 301	416300 416372 416172 263567 416264 416266 416275	x x x x x	x x x x x	x x x x x	Feed Driving Eccentric Friction Plate Adjusting Screw (2) Feed Driving Eccentric Friction Plate Feed Driving Flange Position Screw Feed Driving Flange Set Screw Feed Driving Eccentric Friction Plate Adjusting Screw Set Screw (2)	272115 416264, 416266, 263567, Two 416275, two 416172
263561	302 303	263429 215057	x x x x x	x x x x x	x x x x x	Feed Driving Eccentric Cpl. Feed Driving Eccentric Adjusting Eccentric Pin	215057
416280	304	263430	x x x x x	x x x x x	x x x x x	Feed Driving Eccentric Adjusting Eccentric	
Two 416277	305 306 307	263435 416371 416282	x x x x x	x x x x x	x x x x x	Feed Driving Eccentric Adjusting Eccentric Spring Feed Driving Eccentric Adjusting Eccentric Spring Adjusting Collar Cpl. Feed Driving Eccentric Adjusting Eccentric Spring Adjusting Collar Set Screw (2)	Two 416282
	308 309 310 311 312 313 314 315	416383 416313 416274 416382 416205 263471 276045 276046	x x x x x	x x x x x	x x x x x	Hook Driving Gear (spiral) Sleeve Cpl. Hook Driving Gear (spiral) Sleeve Position Screw Hook Driving Gear (spiral) Sleeve Position Screw Hook Driving Gear (spiral) Sleeve Position Screw Hook Driving Gear (spiral) Cpl. Hook Driving Gear (spiral) Set Screw (2) Hook Driving Gear (spiral) Retaining Ring Hook and Feed Driving Shaft Bushing (back) with Hook and Feed Driving Shaft Bushing (back) Oil Packing (wick)	416274, 416313 Two 416205
235769, 241676 *202056, *203211, *203212, *203213, 203216	316 317 318 319	416300 416406 416267 416381	x x x x x	x x x x x	x x x x x	Hook and Feed Driving Shaft Bushing (back) Set Screw Stitch Length Indicator Cpl. Stitch Length Indicator Set Screw Hook and Feed Driving Shaft Thrust and Timing Collar Cpl.	416267 416274
200594, 200984, 235771, 241674, 241675, two 350405	320 321	416274 416302	x x x x x	x x x x x	x x x x x	Hook and Feed Driving Shaft Thrust and Timing Collar Set Screw Hook and Feed Driving Shaft Connection Belt Pulley Needle Bearing Sleeve Set Screw	

ACCESSORIES

FOR

- 236 U 120
- 236 U 124
- 236 U 130
- 236 U 131
- 236 U 132

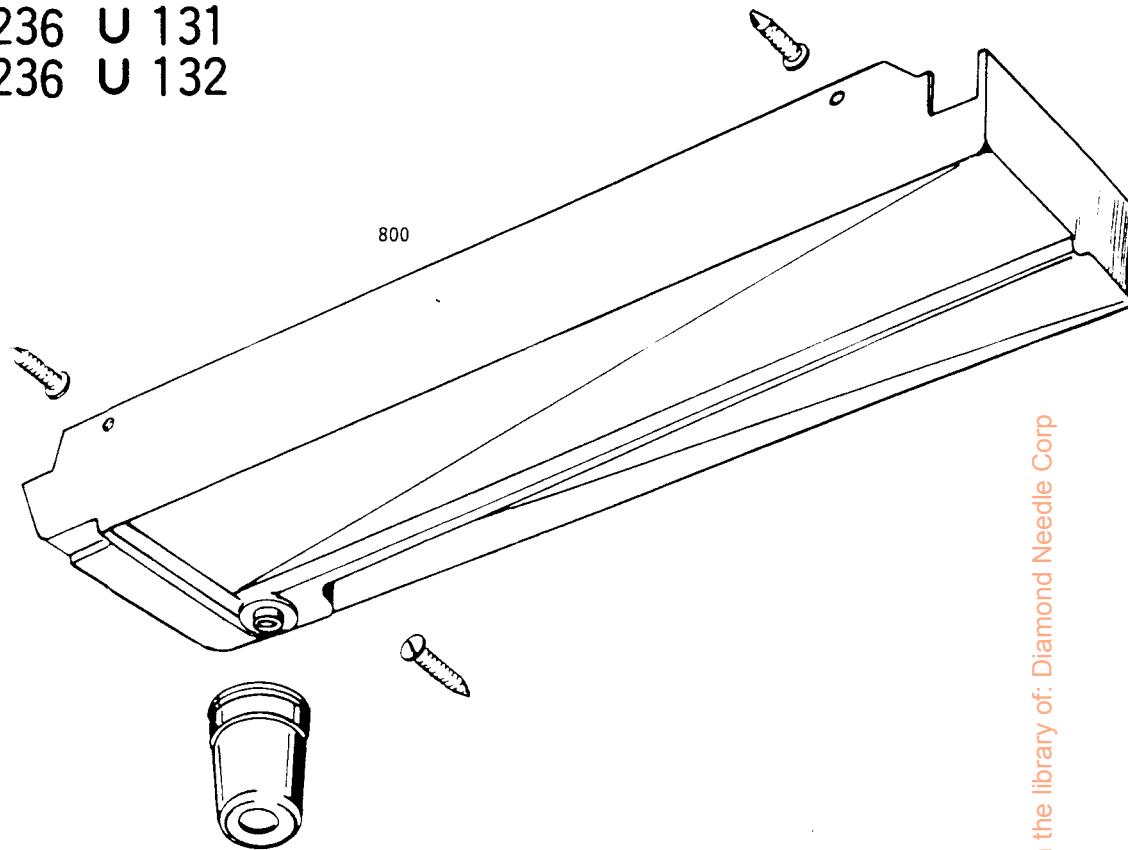

829

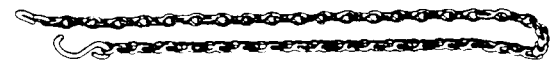

810

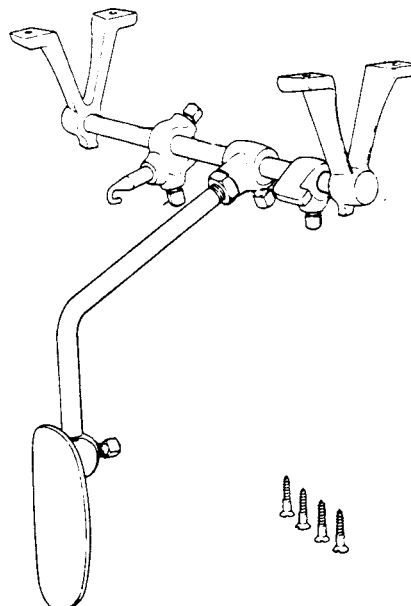

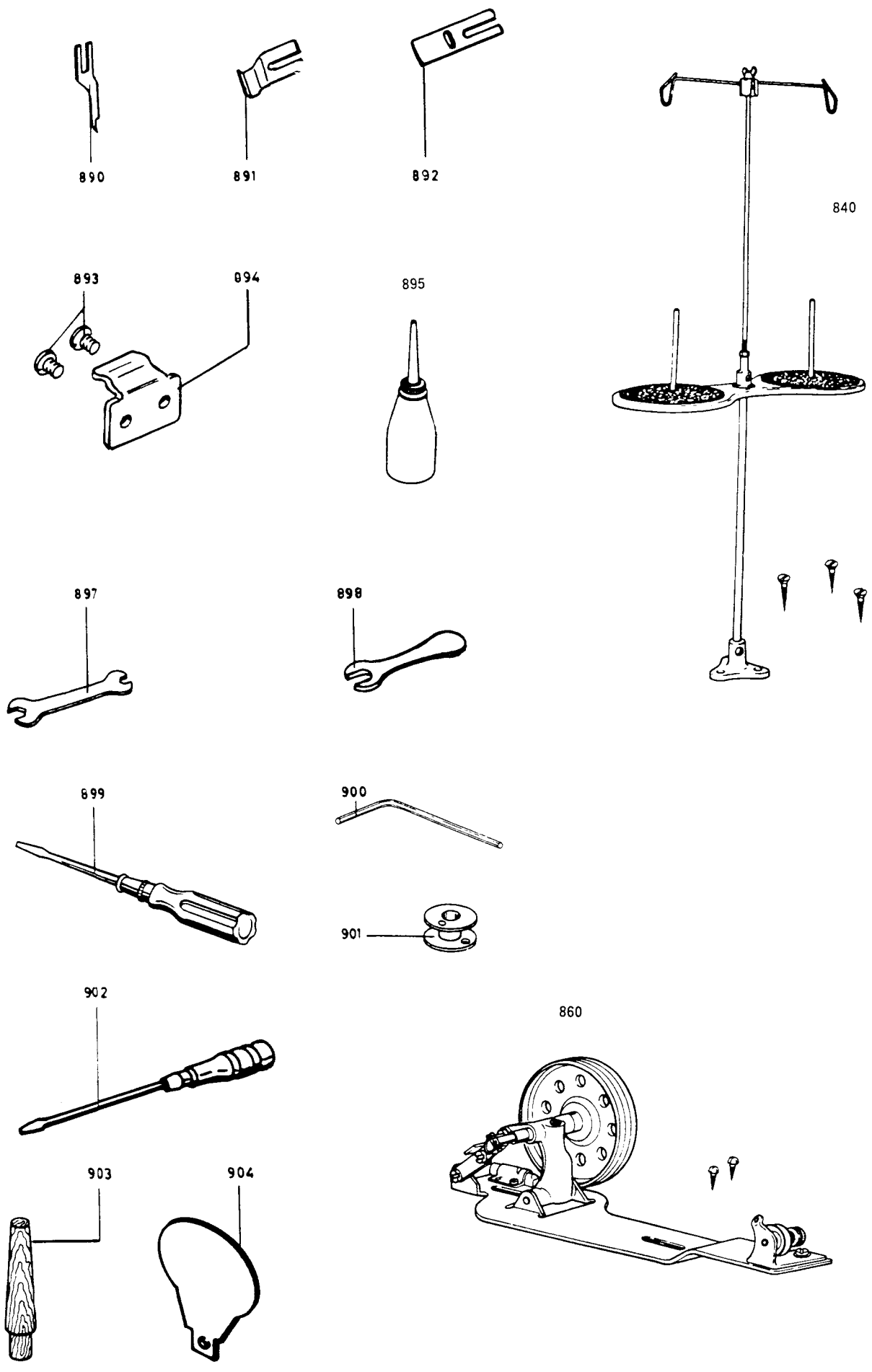

Illustr. Ref. No.	Part No.	For Class			Name	Components	
		120	124	130			131
728	416358				x	Knife Driving Shaft Collar with	416279
729	416279				x	Knife Driving Shaft Collar Set Screw (2)	
730	416436				x	Knife Driving Shaft (eccentric)	Two 416300
731	416359				x	Knife Driving Shaft Pulley (double grooved) for "V" belt, 1-23/32 and 1-13/16 in. dia. belt grooves Cpl.	
732	416300				x	Knife Driving Shaft Pulley Set Screw (2)	
733	263652				x	Arm Base Cover	
734	416250				x	Arm Base Cover Screw (2)	
735	263689				x	Motor Clamping Bracket	
736	416307				x	Motor Clamping Bracket Screw (short) (2)	
737	263671				x	Knife Driving Belt	
738	416222				x	Motor Clamping Bracket Screw (long)	
739	416483				x	Motor Adjusting Screw	

Accessories

800	416164	x	x	x	x	x	Drip Pan Cpl.
810	416163	x	x	x	x	x	Knee Lifter Rock Shaft Cpl.
829	227676	x	x	x	x	x	Rock Shaft Lifting Chain, 18 in. long, with Hook

Thread Unwinder

840	416160	x	x	x	x	x	Thread Unwinder Cpl.
-----	--------	---	---	---	---	---	----------------------

Universal Bobbin Winder

860	503780	x	x	x	x	x	Universal Bobbin Winder
890	248929			x			Knife (3)
891	263735		x			x	Knife (2)
892	238508				x		Knife (2)
893	416286	x	x	x	x	x	Bed Hinge Connection Screw (4)
894	202258	x	x	x	x	x	Bed Hinge Connection (2)
895	517708	x	x	x	x	x	Oiler
897	225544	x	x	x	x	x	Wrench
898	4822	x	x	x	x	x	Roller Presser Hinge Screw Nut Wrench
899	225498	x	x	x	x	x	Screw Driver
900	144465	x	x	x	x	x	Wrench (1/8 in. Hex.)
901	233939	x	x	x	x	x	Bobbin (2)
902	228476	x	x	x	x	x	Screw Driver (bobbin case)
903	41401	x	x	x	x	x	Machine Rest Pin (wood)
904	263577	x	x	x	x	x	Pulley Spreader Cone Adjusting Key
-	1740-141	x	x	x	x	x	Needle (5)

List of Parts 236U120/124/130/131 and 236U132 (Form U34)

Illustr. Ref. No.	Part No.	For Class			Name	Components	Illustr. Ref. No.	Part No.	For Class	
		120	130	132					124	130
322	263569	x	x	x	Hook and Feed Driving Shaft Connection Belt Pulley Needle Bearing Sleeve		437	416294		x
323	263465	x	x	x	Hook and Feed Driving Shaft		438	263731		x
324	416380	x	x	x	Hook and Feed Driving Shaft Connection Belt Pulley Cpl.	214206, 228842, 416315, 416318	439	263732		x
							440	263733		x
325	228842	x	x	x	Hook and Feed Driving Shaft Connection Belt Pulley Needle Bearing		441	416441		x
326	214206	x	x	x	Hook and Feed Driving Shaft Connection Belt Pulley Spring Flange		442	263756		x
327	416315	x	x	x	Hook and Feed Driving Shaft Connection Belt Pulley Position Screw		443	416246		x
328	416318	x	x	x	Hook and Feed Driving Shaft Connection Belt Pulley Set Screw		444	263777		x
329	416368	x	x	x	Feed Driving Crank Cpl.	416468	445	223847		x
330	416468	x	x	x	Feed Driving Crank Pinch Screw		446	250405		x
331	416328	x	x	x	Feed Driving Crank Ball Screw Nut		447	416272		x
332	231836	x	x	x	Feed Driving Crank Thrust Washer		448	263631		x
333	416367	x	x	x	Feed Driving Connection Cpl.	Four 416259	449	263626		x
334	416259	x	x	x	Feed Driving Connection Cap Screw (4)		450	416230		x
335	416214	x	x	x	Feed Driving Crank Ball Screw		451	232154		x
336	263427	x	x	x	Feed Driving Connection Tension Spring		452	263751		x
337	416369	x	x	x	Feed Driving Eccentric Adjusting Eccentric Latch Cpl.	416268	453	263647		x
338	416268	x	x	x	Feed Driving Eccentric Adjusting Eccentric Latch Set Screw		454	263646		x
339	416291	x	x	x	Feed Driving Eccentric Adjusting Eccentric Latch Hinge Pin Position Screw		455	263741		x
340	263432	x	x	x	Feed Driving Eccentric Adjusting Eccentric Latch Hinge Pin		456	416175		x
341	416370	x	x	x	Feed Driving Eccentric Adjusting Eccentric Latch Operating Lever Cpl.	416282	457	263753		x
342	416282	x	x	x	Feed Driving Eccentric Adjusting Eccentric Latch Operating Lever Set Screw		458	263742		x
343	263434	x	x	x	Feed Driving Eccentric Adjusting Eccentric Latch Operating Lever Spring		459	416442		x
344	416397	x	x	x	Roller Presser Driving Belt (lower) Driving Belt Pulley Cpl.	Two 416300	460	416229		x
345	416300	x	x	x	Roller Presser Driving Belt (lower) Driving Belt Pulley Set Screw (2)		461	416444		x
346	263506	x	x	x	Roller Presser Driving Belt (lower)		462	416467		x
347	416396	x	x	x	Roller Presser Driving Belt (lower) Driven Pulley Cpl.	Two 416284	463	416279		x
348	416284	x	x	x	Roller Presser Driving Belt (lower) Driven Pulley Set Screw (2)		464	416443		x
349	416400	x	x	x	Roller Presser Driving Belt (lower) Idler Pulley and Arm Cpl.	416299, 416398, 416399	465	416484		x
350	263512	x	x	x	Roller Presser Driving Belt (lower) Idler Pulley Arm Spring		466	263738		x
351	416399	x	x	x	Roller Presser Driving Belt (lower) Idler Pulley Arm		467	416298		x
352	416398	x	x	x	Roller Presser Driving Belt (lower) Idler Pulley Cpl.	263509, 263513	468	249171		x
353	263509	x	x	x	Roller Presser Driving Belt (lower) Idler Pulley Needle Bearing		469	249162		x
354	263513	x	x	x	Roller Presser Driving Belt (lower) Idler Pulley Needle Bearing		470	416316		x
355	416299	x	x	x	Roller Presser Driving Belt (lower) Idler Pulley Hinge Screw		471	249164		x
356	416204	x	x	x	Roller Presser Driving Belt (lower) Idler Pulley Arm Hinge Screw		472	416234		x
357	263417	x	x	x	Bed Leg (3)		473	416231		x
401	416451	x			Arm Top Cover		474	263750		x
402	263590	x			Arm Top Cover Oil Tube Cpl. (2)	Two 170168	475	263739		x
403	170168	x			Arm Top Cover Oil Tube Metering Insert (2)		476	263735		x
404	263784	x			Knife Driving Mechanism Guard		477	416357		x
405	263781	x			Knife Driving Shaft Driving Gear Lubrication Reservoir Cover		478	350625-806		x
406	416238	x			Knife Driving Shaft Driving Gear Lubrication Reservoir Cover Screw (2)	203100	479	249165		x
407	263782	x			Arm Shaft Bushing (front) with	Two 416277	480	416304		x
408	416450	x			Knife Driving Shaft Driving Gear Cpl.		481	202101		x
409	416277	x			Knife Driving Shaft Driving Gear Set Screw (2)		482	249166		x
410	263407	x			Arm Shaft Bushing (center) with	203100	483	416327		x
411	203100	x			Arm Shaft Bushing (center) Oil Packing (wick)		500	263639		x
412	416173	x			Arm Shaft Bushing (center) Set Screw		501	263640		x
413	416273	x	x	x	Knife Driving Eccentric Position Screw		502	263636		x
414	416306	x	x	x	Knife Driving Eccentric Set Screw		503	416427		x
415	263745	x	x	x	Knife Driving Connection Cpl.	Two 416250, 416445, 263746, 263747, 263748, 416447, 416485	504	416268		x
						416273, 416306	505	416422		x
416	416447	x		x	Knife Driving Eccentric Cpl.		506	416269		x
417	263747	x		x	Knife Driving Connection Bearing (upper) (large)		507	416398		x
418	416250	x		x	Knife Driving Connection Guide Plate Screw (2)		508	263509		x
419	263748	x		x	Knife Driving Connection Guide Plate		509	263513		x
420	416445	x		x	Knife Driving Connection		510	416299		x
421	263746	x		x	Knife Driving Connection Bearing (lower) (small)		511	416429		x
422	416485	x		x	Knife Driving Connection Hinge Screw		512	416268		x
423	416212	x		x	Knife Driving Connection Hinge Screw Nut		513	263628		x
424	263857	x	x	x	Threat Plate Cpl.	Two 141584, 263851, 263856	514	222583		x
425	263856	x	x	x	Threat Plate Needle Plate		515	263620		x
426	263851	x	x	x	Threat Plate Body		516	263648		x
427	141584-819	x	x	x	Threat Plate Needle Plate Screw (2)		517	145-819		x
429	416448	x		x	Thread Lubricator and Edge Guide Bracket Mounting Plate		518	416270		x
430	416174	x		x	Edge Guide Bracket Screw (2)		520	416428		x
431	263734	x		x	Edge Guide Rod Spring Plate		521	416176		x
432	416252	x		x	Edge Guide Rod Spring Plate Screw		522	416177		x
433	416440	x		x	Edge Guide Bracket		523	416465		x
434	416333	x		x	Edge Guide Rod Plunger Nut		524	416178		x
435	263729	x		x	Edge Guide Position Plate		525	263605		x
436	416252	x		x	Edge Guide Position Plate Screw (2)		526	263873		x

From the library of: Diamond Needle Corp

2 Part No. 409843-002)

132	Name	Components	Illustr. Ref. No.	Part No.	For Class			Name
					124	131	132	
x	Edge Guide Rod Lifting Screw		539	416416		x	Knife Bar Driving Connection Cpl.	
x	Edge Guide Rod Plunger		540	416240		x	Knife Bar Driving Link Hinge Stud Pinch	
x	Edge Guide Rod Spring		541	416235		x	Knife Bar Driving Connection Hinge Scre	
x	Edge Guide Rod Spring		542	416276		x	Knife Bar Driving Connection Set Screw	
x	Edge Guide Rod		543	263611		x	Knife Bar Driving Link Hinge Stud	
x	Edge Guide		544	416421		x	Knife Control lever Cpl.	
x	Edge Guide Screw							
	Knife Driving Shaft Cpl.	223847						
	Knife Driving Shaft Oil Packing (wick)							
	Knife Driving Shaft Thrust Washer		545	416319		x	Knife Control Lever Position Spring Adj	
x	Knife Driving Shaft Bushing Set Screw						Plate Screw	
x	Knife Driving Shaft Bushing		546	206482		x	Knife Control Lever Position Spring Adj	
x	Knife Driving Eccentric Thrust Washer						Plate Screw Washer	
x	Knife Driving Shaft Bracket Screw (2)		547	263614		x	Knife Control Lever Hinge Stud	
x	Knife Driving Shaft Bracket Position Pin (2)		548	263618		x	Knife Control Lever Position Spring Adj	
x	Knife Driving Shaft Bracket						Plate	
x	Knife Driving Shaft Oil Tube Packing (wick)		549	416468		x	Knife Control Lever Cpl.	
x	Knife Driving Shaft Bracket Oil Tube		550	232348		x	Knife Control Lever Position Spring Adj	
x	Knife Driving Bell Crank Bracket						Plate Pin	
x	Knife Driving Bell Crank Bracket Screw (2)		551	206482		x	Knife Control Lever Latch Spring Screw	
x	Knife Driving Bell Crank Shaft Retaining Ring		552	40058		x	Knife Control Lever Latch Spring	
x	Knife Driving Bell Crank Shaft		553	350109-803		x	Knife Control Lever Latch Hinge Screw	
x	Knife Driving Arm Cpl.	416229	554	416419		x	Knife Control Lever Latch Cpl.	
x	Knife Driving Arm Pinch Screw		555	416261		x	Knife Control Lever Latch Spring Stop S	
x	Knife Driving Bell Crank		556	416420		x	Knife Control Lever Plate Cpl.	
x	Knife Driving Bell Crank Shaft Collar Cpl.	Two 416279	557	416482		x	Knife Control Lever Latch Adjusting Scr	
x	Knife Driving Bell Crank Shaft Collar Set		558	416325		x	Knife Control Lever Latch Adjusting Scr	
x	Knife Driving Arm Locking Plunger		559	416233		x	Knife Control Lever Plate Screw (2)	
x	Knife Driving Arm Locking Plunger Position Screw		560	416331		x	Knife Control Lever Plate Screw Nut (2)	
x	Knife Driving Arm Locking Plunger Spring		561	545307		x	Knife Control Lever Latch Spring Screw	
x	Knife Driving Arm Unlocking Lever Hinge Screw		562	416240		x	Knife Control Lever Position Spring Scre	
x	Knife Driving Arm Unlocking Lever		563	202603		x	Knife Control Lever Position Spring Scre	
x	Knife Adjusting Plate		564	263617		x	Knife Control Lever Position Spring	
x	Knife Adjusting Plate Screw		565	416425		x	Knife Driving Shaft Bracket Cpl.	
x	Knife Bracket Arm		566	416285		x	Knife Control Lever Hinge Stud Set Scre	
x	Knife Bracket Arm Screw		567	416182		x	Knife Driving Eccentric Cpl.	
x	Knife Driving Arm Retainer and Knife Guard Screw (2)		568	416306		x	Knife Driving Eccentric Set Screw	
x	Knife Guard		569	416273		x	Knife Driving Eccentric Positioning Scre	
x	Knife Driving Arm Retainer		570	416183		x	Bracket (underedge) Cpl.	
x	Knife							
x	Knife Bracket							
x	Knife Screw							
x	Knife Bracket Hinge Pin							
x	Knife Bracket Adjusting Screw		571	267263		x	Knife Bar Position Guide Oiling Wick	
x	Knife Bracket Adjusting Screw		572	416224		x	Knife Bar Position Guide Screw (2)	
x	Knife Bracket Spring		573	416417		x	Knife Bar Position Guide Cpl.	
x	Knife Bracket Adjusting Screw Nut		574	416324		x	Knife Bar Position Guide Pinch Screw Ni	
			575	416225		x	Knife Bar Position Guide Pinch Screw	
			576	416242		x	Knife Holder Screw	
x	Motor and Belt Guard	203100	577	202603		x	Knife Holder Screw Washer	
x	Arm Shaft Bushing (front) with		578	416184		x	Knife Holder Cpl.	
x	Motor Terminal Box Lead Wire Cover Plate		579	416426		x	Knife Holder	
x	Motor Pulley (double grooved) for "V" Belt,		580	200126-806		x	Knife Screw (2)	
	1-13/32 and 1-33/64 in. diam. Belt Grooves		581	416415		x	Knife Bar	
	with	Two 416268	582	248929		x	Knife	
			583	416185		x	Bracket (underedge) Cpl.	
x	Motor Pulley Set Screw (2)		584	248896		x	Knife Bar Bushing (2)	
x	Knife Driving Belt Idler Pulley Adjusting Stud		585	416186		x	Knife Bar Bushing Screw	
x	Knife Driving Belt Idler Pulley Adjusting Stud		586	416356		x	Bracket (underedge)	
x	Knife Driving Belt Idler Pulley Cpl.	*263509, 263513	587	416481		x	Bracket (underedge) Screw (2)	
x	Knife Driving Belt Idler Pulley		588	416310		x	Guide Finger Clamp Bar Bushing Set Scre	
x	Knife Driving Shaft Belt Pulley Hinge Screw		589	416187		x	Knife Bar Sleeve Set Screw Cpl.	
x	Knife Driving Shaft Belt Pulley with	Two 416268	590	416228		x	Knife Bar Sleeve Set Screw	
x	Knife Driving Shaft Belt Pulley Set Screw (2)		591	416320		x	Knife Bar Sleeve Set Screw Nut	
x	Knife Driving Shaft with	222583	592	204411		x	Knife Bar Sleeve	
x	Knife Driving Shaft Oil Packing (wick) (in shaft)		593	248896		x	Guide Finger Clamp Bar Bushing	
x	Knife Driving Belt		594	204365		x	Guide Finger Clamp Bar Spring	
x	Arm Cover (front) (motor vent)		595	416188		x	Guide Finger Clamp Bar Position Guide (
x	Motor Terminal Block Screw (furnished with motor)		596	416352		x	Guide Finger Clamp Bar Position Guide (
x	Motor Set Screw (2)							
x	Roller Presser and Bar Cpl.	Two 416249, 202558, 416343,	597	36737		x	Guide Finger Disengaging Lever Friction	
		202559, 416351, 416350,	598	204389		x	Guide Finger Disengaging Lever Friction	
		416394, 416243, 416176					Spring	
		416177, 416392	599	416280		x	Guide Finger Clamp Bar Position Guide	
	Roller Presser Arm Cpl.	1528, 201699, twenty-eight	600	416237		x	Guide Finger Clamp Bar Position Guide	
	Roller Presser Cpl.	206417, 350104	601	241626		x	Guide Finger Disengaging Lever	
	Feed Post Cpl.	Two 545318, 249019, 249092,	602	416354		x	Guide Finger Clamp Bar	
		416161, 263461, 416379,	603	416353		x	Guide Finger Bracket Cpl.	
		416178, 263829, 416162,	604	416209		x	Guide Finger Clamp Bar Stop Adjusting	
		416461, 263849, 416274					Thumb Nut (2)	
	Feed Wheel Cpl.	Three 416290, sixty 206417,	605	416312		x	Guide Finger Clamp Bar Stop Adjusting	
		416373, 416374, 416375,	606	416471		x	Guide Finger Bracket Screw	
		263605	607	416355		x	Guide Finger Clamp Bar Position Guide	
	Feed Wheel		608	204361		x	Guide Finger Clamp Bar Latch	
	Throat Plate Cpl.	Two 416180, 263871, 416179	609	416189		x	Guide Finger Clamp Bar Latch Spring Cp	
	Throat Plate Knife Cutting Plate		610	204230		x	Guide Finger Clamp Bar Latch Spring	
	Throat Plate Body		611	416295		x	Guide Finger Clamp Bar Latch Hinge Scr	
	Throat Plate Knife Cutting Plate Screw (2)		612	416288		x	Guide Finger Clamp Bar Position Guide	
	Knife Bar Driving Connection Cpl.	222013, 416416, 263611,	613	416296		x	Guide Finger Screw	
		263627, 416423, 416424,	614	248878		x	Guide Finger	
		508378	615	248879		x	Guide Finger with projection to guard K	
	Knife Driving Connection						(furnished in place of 248878 if specified	
	Knife Driving Connection Hinge Pin Cpl.	272115					order)	
	Knife Driving Connection Hinge Pin Oiling Wick		616	276046		x	Knife Driving Shaft Oil Wick (in arm)	
	Knife Driving Connection Plunger Cpl.	416293						
	Knife Driving Connection Plunger Screw							
	Knife Driving Connection Plunger Spring		630	263677		x	Knife Driving Lever Guard	
	Knife Driving Link Cpl.	416281	631	416316		x	Knife Driving Lever Guard Screw (2)	
	Knife Driving Connection Hinge Pin							
	Position Screw							

From the library Diamond Needles Corp

Components	Illustr. Ref. No.	Part No.	For Class			Name	Components
			124	131	132		
416240, 416235, 416276	632	203411		x		Knife Driving Lever Guard Screw Washer (2)	
	635	416472		x		Feed Post Base Cover Screw (2)	
	638	263853		x		Throat Plate Cpl.	Two 141584, 263851, 263852
	639	263852		x		Throat Plate Needle Plate	
	640	263851		x		Throat Plate Body	
545307, 40058, two 416233, 416319, two 416331, two 206482, 416419, 416420, 263618, 350109, 416418	642	416439		x		Knife Guard Holder Cpl.	416257, 416322, 225837, 263681, 416437, 416438, 263684
	643	416322		x		Knife Guard Holder Hinge Screw Nut	
	644	225837		x		Knife Guard Holder Hinge Screw Washer	
	645	263684		x		Knife Guard Holder Spring	
	646	416438		x		Knife Guard Holder Bracket	
	647	416257		x		Knife Guard Set Screw	
	648	263681		x		Knife Guard	
	649	416437		x		Knife Guard Holder Cpl.	416284
	650	416284		x		Knife Guard Set Screw	
232348	651	416206		x		Knife Guard Holder Bracket Screw (2)	
	652	416190		x		Hook Post Cpl.	416136, 545342, two 544322, two 544303, 416215, 416170, 203478, 234426, 263421, 263464, 263476, 416169, 263479, 263480, 263481, 416466, 263482, 416410, 263593, 263826, 416413, 416463, 416478, four 263093 Two 263582
416261							
416325, 416482	653	416463		x		Hook Post with	
	654	263093		x		Knife Bracket Arm Oil Packing (wick) (4)	416201, 541178, 1443, 7071, 206840, 241732, 263656, 263862, 263863, 263864, 416462, 263861, two 545239, two 416206
	664	416464		x		Edge Guide Bracket Cpl.	
	665	545239		x		Edge Guide Screw (2)	
416285	666	241732		x		Edge Guide	
	667	263861		x		Edge Guide Bracket	
416273, 416306	668	206840		x		Edge Guide Bracket Hinge Stud Spring Washer	
	669	263656		x		Edge Guide Bracket Hinge Stud	
	670	263864		x		Edge Guide Bracket Release Spring	
Two 416224, 416242, 416288, 416242, 202603, 416189, 204361, 204365, 416188, 416185, 416353, 416354, 416355, 416415, 263610, 416417, 416184, 267263, 416471	671	416462		x		Edge Guide Bracket Support Cpl.	416213
	672	416213		x		Edge Guide Bracket Hinge Stud Set Screw	
	673	1443-806		x		Edge Guide Bracket Release Lever Spring Screw	
	674	7071-806		x		Edge Guide Bracket Release Lever Spring Washer	
	675	263863		x		Edge Guide Bracket Release Lever Spring (flat)	
	676	263862		x		Edge Guide Bracket Release Lever	
	677	541178		x		Edge Guide Bracket Release Lever Hinge Screw Nut	
	678	416201		x		Edge Guide Bracket Release Lever Hinge Screw	
	679	416206		x		Edge Guide Bracket Support Screw (2)	
416225, 416324	681	504110		x		Feed and Hook Post Cover (back or front) Screw (4)	
	682	416191		x		Knife Bracket Arm Cpl.	463, two 416253, 416431, 416432, 263669, 263670, 263840, 416470, 416473
	683	416253		x		Knife Screw (2)	
Two 200126, 416426	684	416431		x		Knife Bracket	
	685	263840		x		Knife Bracket Adjusting Screw Lock Screw Packing (nylon)	
	686	416473		x		Knife Bracket Adjusting Screw	
	687	463-830		x		Knife Bracket Adjusting Screw Lock Screw	
416186, 416187, 416310, 204411, 416356, three 248896	688	263669		x		Knife Bracket Hinge Pin	
	689	263670		x		Knife Bracket Spring	
	690	416470		x		Knife Bracket Spring Screw	
	691	416432		x		Knife Bracket Arm	
	692	238508		x		Knife	
	693	263688		x		Knife Switch-out Plunger	
	694	416192		x		Knife Switch-in Lever Cpl.	416193
416228, 416320	695	416193		x		Knife Switch-in Lever Pinch Screw	
	696	416337		x		Knife Bracket Arm Spring Adjusting Collar Cpl.	416275
	697	416275		x		Knife Bracket Arm Spring Adjusting Collar Set Screw	
	698	263668		x		Knife Bracket Arm Spring	
416352, 241626 36737, 416237, 416280, 204389	699	416194		x		Knife Driving Lever (upper) Cpl.	416332, 241721, 416434, 416435
	700	416332		x		Knife Driving Lever (upper) Locking Plunger Spring Thumb Nut Cpl.	416281
	701	416281		x		Knife Driving Lever (upper) Locking Plunger Spring Thumb Nut Set Screw	416229
	702	416434		x		Knife Driving Lever (upper) Cpl.	
	703	416229		x		Knife Driving lever (upper) Pinch Screw	
	705	241721		x		Knife Driving Lever (upper) Locking Plunger Spring	
416209, 416312	706	416435		x		Knife Driving Lever (upper) Locking Plunger	
	707	263687		x		Knife Switch-out Lever	
	708	416260		x		Knife Switch-out Lever Hinge Screw	
	*711	249288		x		Knife Driving Lever Fork	
	712	416229		x		Knife Driving Fork Lever (lower) Pinch Screw	
	713	24173		x		Knife Driving Lever Fork Swivel	
416209, 416312	714	416202		x		Knife Driving Lever Fork Swivel Screw	
204230, 416295	715	241738		x		Knife Driving Fork Lever (lower) Shaft	
	720	263673		x		Knife Driving Fork Lever (lower) Cpl.	416202, 24173, 416433, 241738 416229,* 249288
	721	416433		x		Knife Driving Fork Lever (lower) with Knife Driving Lever Fork Slide Block Cap Screw	
	722	416244		x		Knife Driving Lever Fork Slide Block Cap Screw	
	723	249289		x		Knife Driving Lever Fork Slide Block	
	724	263680		x		Knife Driving Shaft Housing with Knife Driving Shaft Bearing (2)	Two 263679
	725	263679		x		Knife Driving Shaft Housing Screw (4)	
	726	129-805		x		Knife Driving Lever Fork Slide Block Oiling Wick	
	727	249298		x			